

Sizing plates perform a critical function in the extrusion process. When plastic is extruded it expands slightly as it leaves the extrusion die. Then, as it cools it passes through a series of Sizing Plates that bring the extrusion to the desired size and shape.

SelfLube manufactures Sizing Plates in a broad range of customer specified sizes. The Company has produced over a million precision plates for the tooling industry, an accomplishment that attests to the fact that it consistently delivers high value to its customers.

- Custom made to customer specs
- Stainless steel
- Furnished fully machined and ready for EDM
- Also see Rectangular Sizing Plates

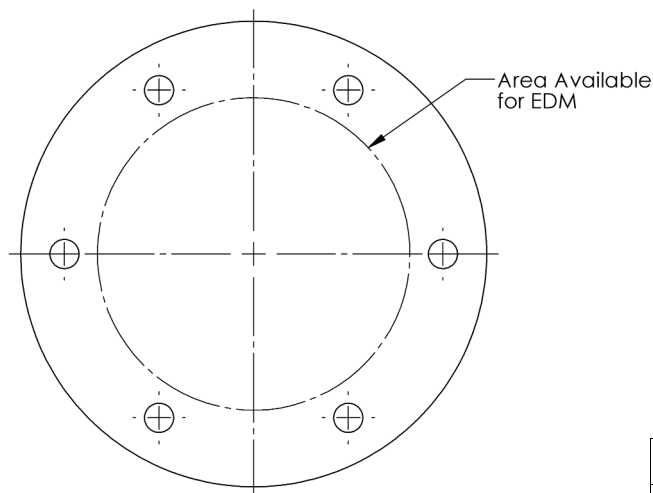
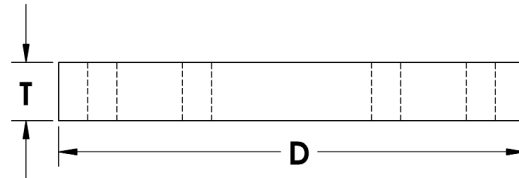

(Not an actual part)

Materials: Stainless Steel

Ordering Note: To obtain a quote simply supply us with a drawing or CAD model (Parasolid or STEP preferred) and we will do the rest.

Standard Tolerances	
Diameter (D)	+/- .010
Thickness (T)	+/- .005
<i>Locating Holes</i>	
Size	+/- .001
Location	+/- .001
<i>Other Holes</i>	
Size	+/- .005
Location	+/- .005