

Type 1

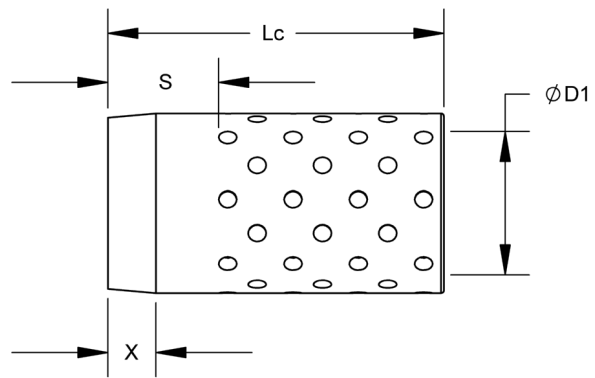

Type 2

TYPE 1				
Catalog Number	D1	Lc	S	X
C25.008.006	1.00	1.50	0.4375	0.1875
C25.008.008		2.00	0.6875	
C25.010.006	1.25	1.50	0.4375	
C25.010.008		2.00	0.6875	
C25.012.008	1.50	2.00	0.6875	0.2500
C25.012.010		2.50	0.9375	
C25.014.010	1.75	2.50	0.9375	
C25.014.012		3.00	1.1875	
C25.016.012	2.00	3.00	1.1875	0.3750
C25.016.014		3.50	1.4375	
C25.020.016	2.50	4.00	1.6875	
C25.024.016	3.00	4.00	1.6875	

TYPE 2				
Catalog Number	D1	Lc	S	X
C26.012.018	1.50	4.50	2.4375	0.2500
C26.012.020		5.00	2.9375	
C26.012.022		5.50	3.4375	
C26.012.024	6.00	3.9375		
C26.014.013	1.75	3.25	1.6875	
C26.014.016		4.00	2.0625	
C26.014.019		4.75	2.4375	
C26.014.021		5.25	2.9375	
C26.014.023		5.75	3.4375	
C26.014.025		6.25	3.9375	
C26.014.027	6.75	4.4375		
C26.016.015	2.00	3.75	1.9375	
C26.016.018		4.50	2.3125	
C26.016.021		5.25	2.6875	
C26.016.023		5.625	3.0625	
C26.016.024		6.00	3.4375	
C26.016.026		6.50	3.9375	
C26.016.028		7.00	4.4375	
C26.016.030		7.50	4.9375	
C26.020.023	2.50	5.75	3.0000	
C26.020.026		6.50	3.3750	
C26.020.029		7.25	3.7500	
C26.020.031		7.75	4.2500	
C26.020.033		8.25	4.7500	
C26.020.035		8.75	5.2500	
C26.024.023	3.00	5.75	3.0000	
C26.024.026		6.50	3.3750	
C26.024.029		7.25	3.7500	
C26.024.031		7.75	4.2500	
C26.024.033		8.25	4.7500	
C26.024.035		8.75	5.2500	

TYPE 2				
Catalog Number	D1	Lc	S	X
C26.008.008	1.00	2.00	1.0625	0.1875
C26.008.010		2.50	1.3125	
C26.008.012		3.00	1.5625	
C26.008.013		3.25	1.8125	
C26.008.014		3.50	2.0625	
C26.008.015		3.75	2.3125	
C26.010.011	1.25	2.75	1.4375	
C26.010.013		3.25	1.6875	
C26.010.015		3.75	1.9375	
C26.010.016		4.00	2.1875	
C26.010.017		4.25	2.4375	
C26.010.019		4.75	2.9375	
C26.012.011	1.50	2.75	1.4375	0.2500
C26.012.014		3.50	1.8125	
C26.012.017		4.25	2.1875	
C26.012.017		4.25	2.1875	